

LOADPRO 250W LED GRID DIMMER

RLA250DTG-01

PLEASE READ INSTRUCTION BEFORE COMMENCING INSTALLATION AND RETAIN FOR FUTURE REFERENCES.

! Electrical products can cause death or injury, or damage to property. If in any doubt about the installation or use of this product, consult a competent electrician

Note:

Product technical information and specification may change over time without prior notification For the latest technical information please visit our web site www.robus.com or robustirect.com

Push-on/push-off switch dimmer for resistive, inductive LV and inductive LED lighting loads. Trailing edge dimmer.

Supply: 220/240V 50Hz; 0 ° C <T_a <+ 40 °

Loading Information: LV Halogen / Incandescent: 10-400W; LED: 5-250W

! Do Not use this dimmer with wire wound transformers, fans or electric motors or locate it in an area with high humidity.

Installation

1 Ensure mains supply is switched off before commencing work.

2 Remove existing switch from wall, taking note of wiring connections.

3 Connect existing wires as per circuit diagram, ensuring all terminals are secure.

Note: Only one dimmer can be used on a dimming circuit. Where there are two or more switching points on a circuit use one dimmer and a standard 2-Way switch.

Adjust the Min./Max. Light Level:

Switch the dimmer on

Using a screw driver adjust Min. and Max.

brightness pots the on the dimmer

Min. Brightness: Turn knob to minimum, adjust pot to desired light levels

Max. Brightness: Turn knob to maximum, adjust pot to desired light levels

Information for the Product user:

- Please note the requirement to dispose of Waste Electrical & Electronic Equipment separately from household waste (WEEE marked with crossed out wheellie bin symbol).
- Please consider your role in contributing to re-use and recycling by returning this product at end of life to a collection centre for waste electrical equipment or a Civic Amenity site, or to a retail outlet from which you are purchasing a replacement.
- This equipment may contain substances that are hazardous to health and the environment if disposed of carelessly. It is important that it is separated from normal household waste and recycled in the WEEE chain
- The "crossed out wheellie bin symbol" on a product indicates this equipment must not be disposed of in normal household waste, but should be disposed of according to local WEEE regulations

The Installation must be carried out by a qualified electrician

Dimension

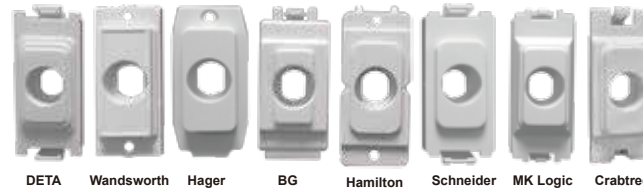
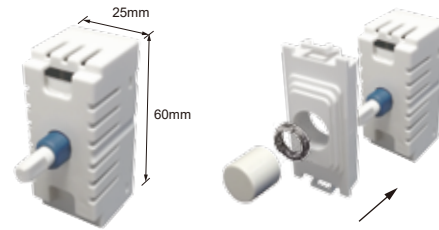

Wiring: TWO WAY DIMMER CIRCUIT

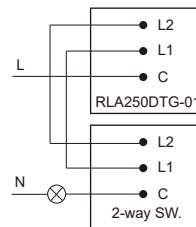

ONE WAY DIMMER CIRCUIT

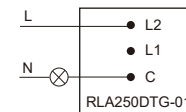

L.E.D lighting & Electrical Distribution Group UC
 IRE: Nangor Road, Dublin 12, D12 E7VP, Ireland
 UK: Bracknell Enterprise & Innovation Hub, Ocean House, 12th Floor, The Ring, Bracknell, Berkshire RG12 1AX, UK

Tel: +353 1 7099000
 Fax: +353 1 7099060
 Email: info@robus.com
 Website: www.robus.com

